

# How to Install

**EASY-UP™**  
RETRACTABLE MIRROR

## Toggle Bolt Hook

For plaster or drywall ceilings (Fig-1)

1. Drill a hole in the ceiling to the same diameter as the closed wings (A).
2. Assemble toggle bolt by screwing bolt (B) into wings (A).
3. Insert toggle bolt into newly drilled hole. Toggle bolt should extend past the ceiling for step 4.
4. Lock the assembly by screwing the hook (C) onto the extended portion of bolt (B) as shown.
5. Attach ring at the top of the EASY-UP mirror box onto the hook.

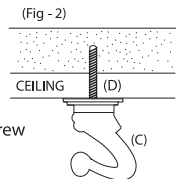
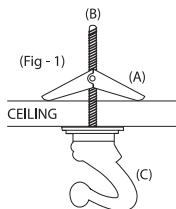

## Screw-In Hook

For wood beams or ceilings (Fig-2)

1. When using the assembly for a wood beam ceiling: Screw pointed screw (D) into hook (C).
2. Screw the hook and screw assembly into the wood.
3. Attach ring at the top of the EASY-UP mirror box onto the hook.

## Track Hook

For drop ceilings (Fig-3)

1. Open hook (E), then close hook over the existing metal drop ceiling track.
2. Attach ring at the top of the EASY-UP mirror box onto the hook.

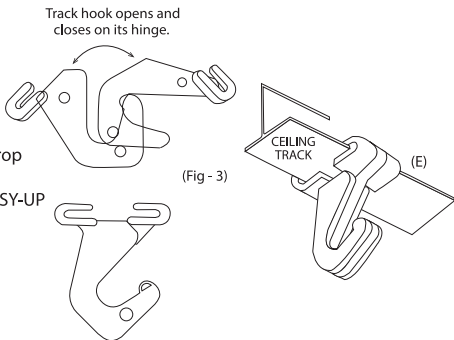

**OptiSource™**  
The Optical Supply Resource

1-800-OptiSource (678-4768) | 1-800-optisource.com

